

Agilent 7820A

Gas Chromatograph

Quick Start Guide

Guia de inicio rápido

クイック・スタートガイド

快速启动指南

7820A - Guide de mise en route

7820A - Guida rapida

7820A Schnellstarthandbuch

Guía de iniciación rápida del

7820A

**Руководство по быстрому
началу работы с 7820A**



Agilent Technologies

Notices

© Agilent Technologies, Inc. 2009

No part of this manual may be reproduced in any form or by any means (including electronic storage and retrieval or translation into a foreign language) without prior agreement and written consent from Agilent Technologies, Inc. as governed by United States and international copyright laws.

Manual Part Number

G4350-90008

Edition

Second edition, April 2009

First edition, March 2009

Printed in China

Agilent Technologies, Inc.
412 Ying Lun Road
Waigaoqiao Free Trade Zone
Shanghai 200131 P.R.China

安捷伦科技（上海）有限公司
上海市浦东新区外高桥保税区
英伦路 412 号
联系电话：（800）820 3278

Warranty

The material contained in this document is provided “as is,” and is subject to being changed, without notice, in future editions. Further, to the maximum extent permitted by applicable law, Agilent disclaims all warranties, either express or implied, with regard to this manual and any information contained herein, including but not limited to the implied warranties of merchantability and fitness for a particular purpose. Agilent shall not be liable for errors or for incidental or consequential damages in connection with the furnishing, use, or performance of this document or of any information contained herein. Should Agilent and the user have a separate written agreement with warranty terms covering the material in this document that conflict with these terms, the warranty terms in the separate agreement shall control.

Technology Licenses

The hardware and/or software described in this document are furnished under a license and may be used or copied only in accordance with the terms of such license.

Restricted Rights

If software is for use in the performance of a U.S. Government prime contract or subcontract, Software is delivered and licensed as “Commercial computer software” as defined in DFAR 252.227-7014 (June 1995), or as a “commercial item” as defined in FAR 2.101(a) or as “Restricted computer software” as defined in FAR 52.227-19 (June 1987) or any equivalent agency regulation or contract clause. Use, duplication or disclosure of Software is subject to Agilent Technologies’ standard commercial license terms, and non-DOD Departments and Agencies of the U.S. Government will

receive no greater than Restricted Rights as defined in FAR 52.227-19(c)(1-2) (June 1987). U.S. Government users will receive no greater than Limited Rights as defined in FAR 52.227-14 (June 1987) or DFAR 252.227-7015 (b)(2) (November 1995), as applicable in any technical data.

Safety Notices

A **CAUTION** notice denotes a hazard. It calls attention to an operating procedure, practice, or the like that, if not correctly performed or adhered to, could result in damage to the product or loss of important data. Do not proceed beyond a **CAUTION** notice until the indicated conditions are fully understood and met.

A **WARNING** notice denotes a hazard. It calls attention to an operating procedure, practice, or the like that, if not correctly performed or adhered to, could result in personal injury or death. Do not proceed beyond a **WARNING** notice until the indicated conditions are fully understood and met.

Agilent 7820A Gas Chromatograph 7820A Quick Start Guide



English

1. **Locate the GC and GC/MS Hardware User Information & Utilities DVD.**

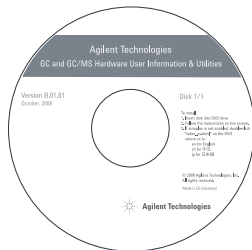

2. **Insert DVD.**

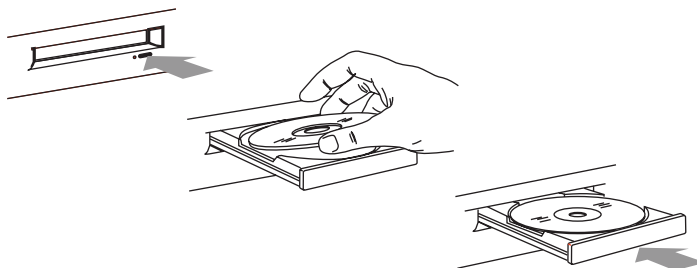

3. **Select language.**



Agilent Technologies

4. Click View Hardware Manuals & Videos.

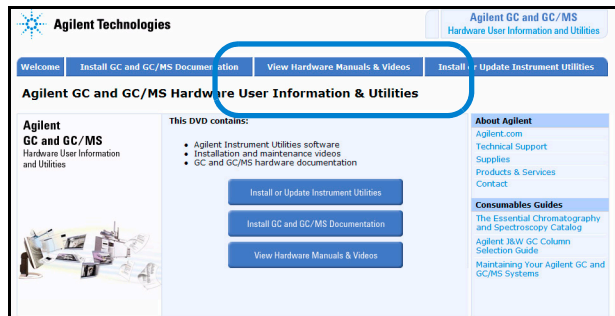

5. Scroll down. Expand GC Documentation. Expand 7820A GC Documentation.

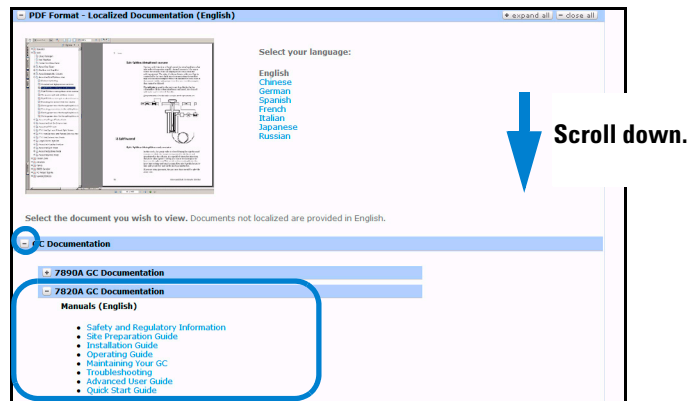

6. Open the Installation Guide. Follow the instructions to install the Agilent 7820A GC.

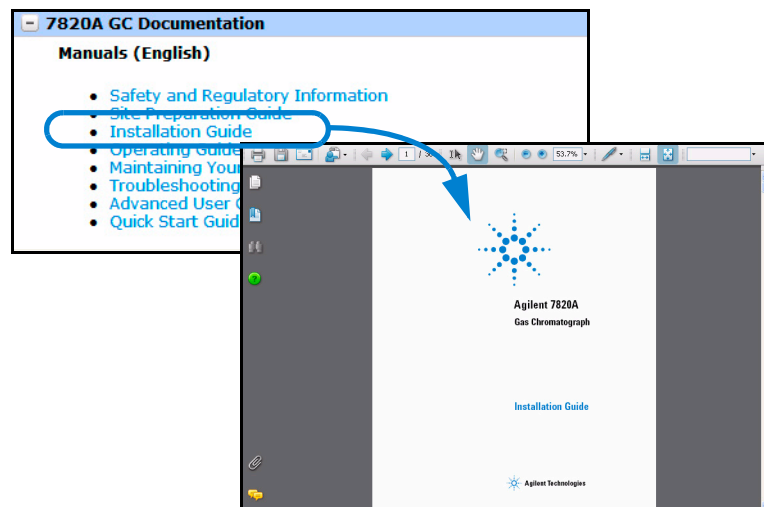

Other Information

Important

See your Agilent GC and GC/MS Hardware User Information & Utilities DVD that ships with your instrument for localized versions of Safety and Regulatory, Operation, Maintenance, and Troubleshooting information.

Online User Documentation

Now your Agilent instrument documentation is in one place, at your fingertips.



The Agilent GC and GC/MS Hardware User Information & Utilities DVD that ships with your instrument provides an extensive collection of online help, videos, and books for current Agilent gas chromatographs, mass selective detectors, and GC samplers. Included are localized versions of the information you need most, such as:

- Getting Familiar documentation
- Safety and Regulatory guide
- Site Preparation information
- Installation information
- Operating guides
- Maintenance information
- Troubleshooting details



Cromatógrafo a gás Agilent 7820A Guia de início rápido

Português

1. Localize o **DVD GC and GC/MS Hardware User Information & Utilities.**

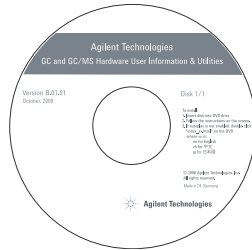

2. Insira o DVD.

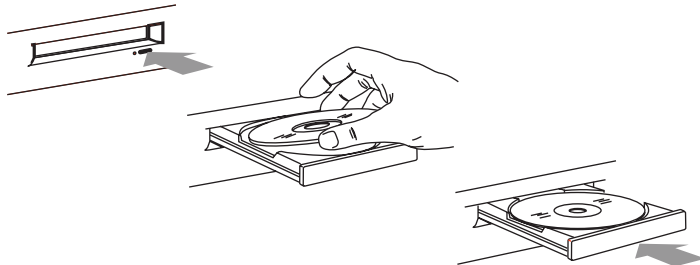

3. Selecione o idioma.



4. Clique em **View Hardware Manuals & Videos** (Exibir vídeos e manuais do hardware).

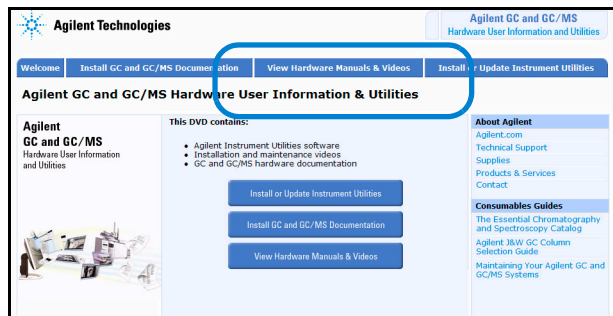

5. Vá descendo na tela. Abra a lista de documentação do GC. Abra a lista de documentação do GC 7820A.

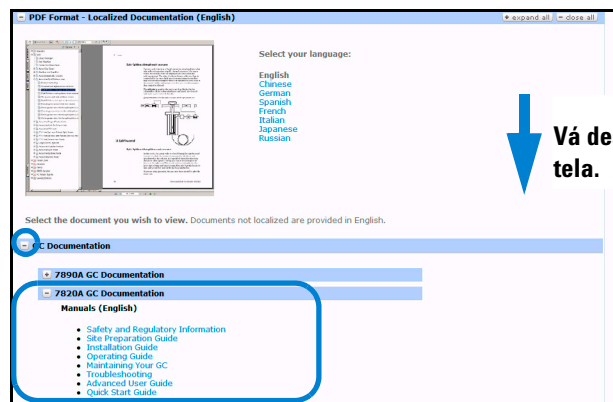

6. Abra o **Installation Guide**. Siga as instruções para instalar o cromatógrafo a gás Agilent 7820A.

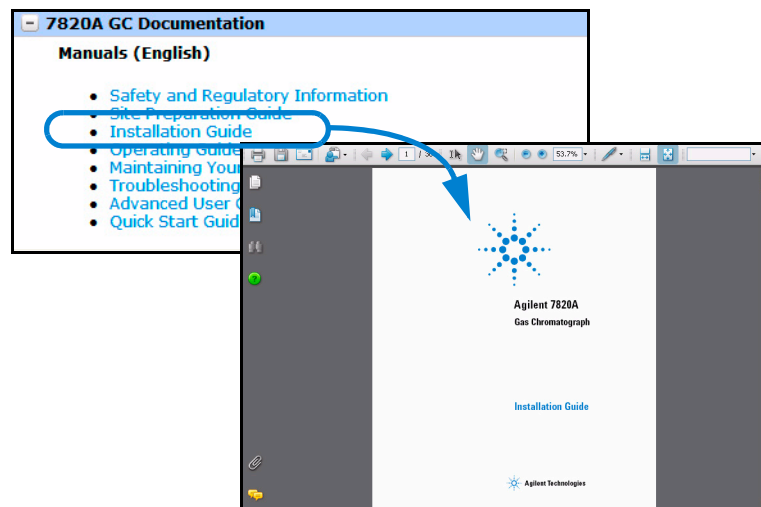

Outras informações

Importante

No DVD fornecido junto com o instrumento (*Agilent GC and GC/MS Hardware User Information & Utilities*), consulte as informações em português sobre segurança, regulamentações, operação, manutenção e solução de problemas.

Documentação de usuário on-line

Agora a documentação do seu instrumento da Agilent fica toda em um único local, sempre à mão.



O DVD *Agilent GC and GC/MS Hardware User Information & Utilities*, que acompanha o instrumento, oferece um conjunto abrangente de vídeos, livros e ajuda on-line para os cromatógrafos a gás (CG), detectores seletivos de massa (MS) e equipamentos coletores de amostras de GC. Estão incluídas as traduções das informações mais necessárias, como:

- Documentação de apresentação do produto
- Guia de segurança e regulamentação
- Informações sobre a preparação do local
- Informações de instalação
- Guias de operação
- Informações de manutenção
- Detalhes de solução de problemas

Agilent 7820A ガスクロマトグラフ クイックスタートガイド

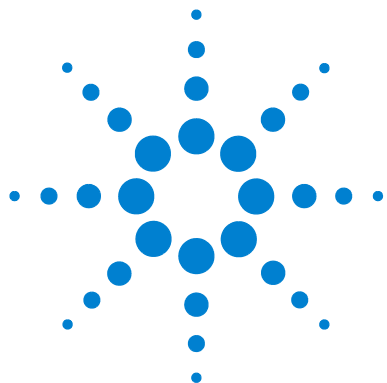

日本語

1. GC and GC/MS
Hardware User
Information & Utilities
DVD をパッケージ
から取り出します。



2. DVD を挿入します。

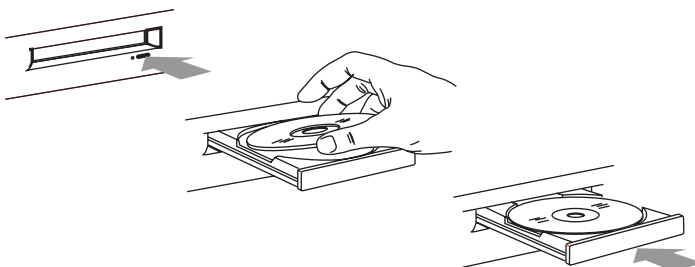

3. 言語を選択します。



4. [ハードウェアの
マニュアルおよび
ビデオの表示]
をクリックします。



5. 下にスクロールします。
[GC ドキュメント]
を展開し、[7820A GC
ドキュメント]
を展開します。

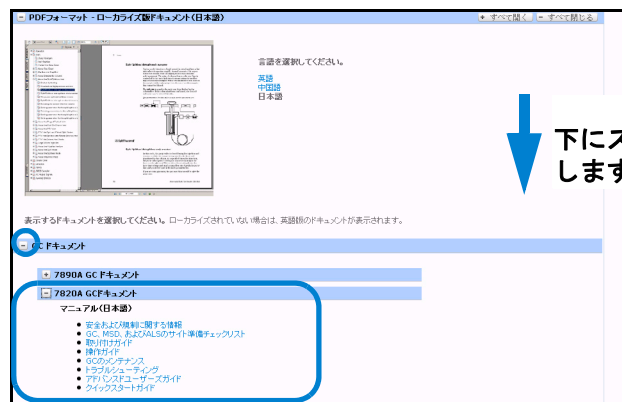

6. インストールガイドを
開きます。インストール
ガイドの指示に従って、
Agilent 7820A GC を
インストールします。



その他の情報

重要

安全および規制、操作、メンテナンス、トラブルシューティングに関する情報の各国語版については、機器に付属の Agilent GC and GC/MS Hardware User Information & Utilities DVD を参照してください。

オンラインユーザーマニュアル

Agilent 機器に関するマニュアル類を一箇所で簡単に閲覧できるようになりました。



機器に付属の Agilent GC and GC/MS Hardware User Information & Utilities DVD には、現行の Agilent ガスクロマトグラフ、質量選択検出器、および GC サンプラに関するオンラインヘルプ、ビデオ、マニュアルが数多く収録されています。以下のような重要な情報の各国語版が含まれています。

- 基礎知識に関するマニュアル
- 安全および規制に関するガイド
- 設置準備に関する情報
- 据付に関する情報
- 操作ガイド
- メンテナンス情報
- トラブルシューティングの詳細情報

Agilent 7820A 气相色谱仪 快速启动指南

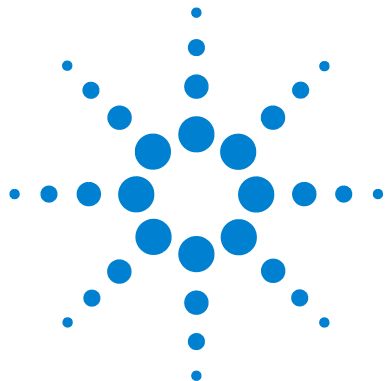

中文

1. 找到 GC 硬件用户信息与实用程序 DVD。

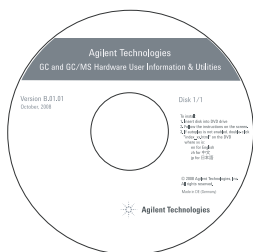

2. 插入 DVD。

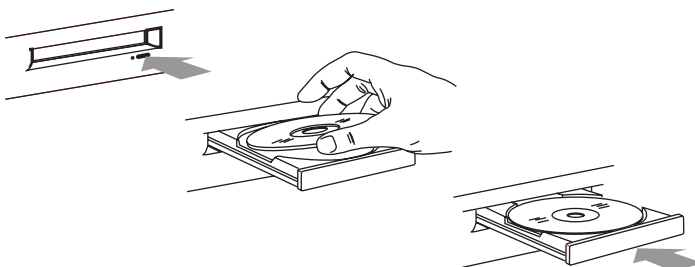

3. 选择语言。



4. 单击查看硬件手册和视频。



5. 向下滚动展开 GC 文档
展开 7820A GC 文档。

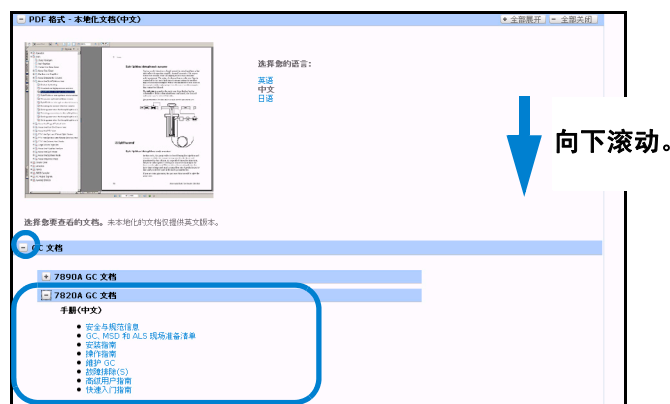

6. 打开安装指南按照说明
安装 Agilent 7820A GC。



其他信息

重要信息

有关安全与规范、操作、维护和故障排除的本地化版本，请参阅仪器附带的 **Agilent GC 硬件用户信息和实用程序 DVD**。

联机用户文档

现在 **Agilent** 仪器文档集中于一处，对您而言触手可及。



有关当前 **Agilent** 气相色谱仪和 GC 进样器的联机帮助、视频和手册都可以在仪器附带的 **Agilent GC 硬件用户信息和实用程序 DVD** 上找到。包含您所需信息的本地化版本，例如：

- 熟悉产品文档
- 安全与规范指南
- 现场准备信息
- 安装信息
- 操作指南
- 维护信息
- 故障排除详细信息



Agilent 7820A Chromatographe en phase gazeuse 7820A - Guide de mise en route

Français

1. Prenez le DVD GC and GC/MS Hardware User Information & Utilities.

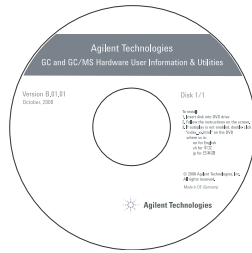

2. Insérez le DVD.

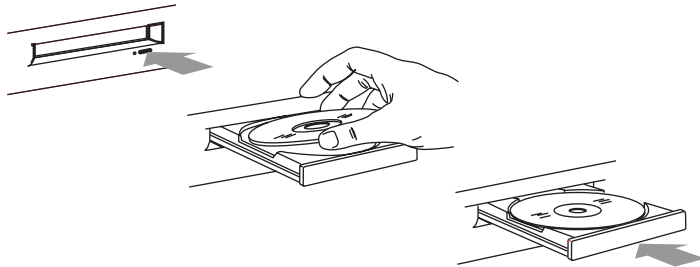

3. Sélectionnez la langue.



4. Cliquez sur View Hardware Manuals & Videos.

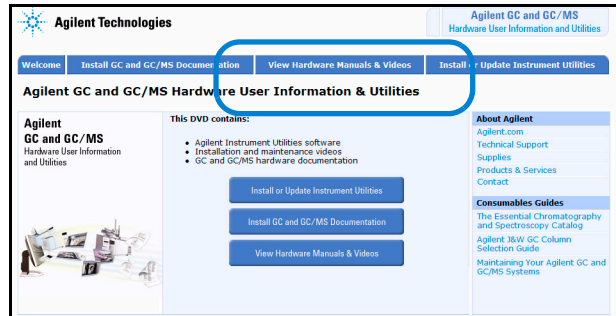

5. Naviguez vers le bas de la page. Cliquez sur la documentation du CPG. Cliquez sur la documentation du CPG 7820A.

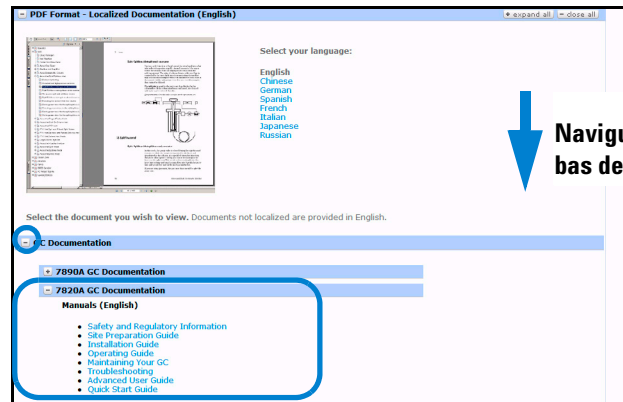

6. Ouvrez le Guide d'installation. Suivez les instructions pour installer le CPG Agilent 7820A.

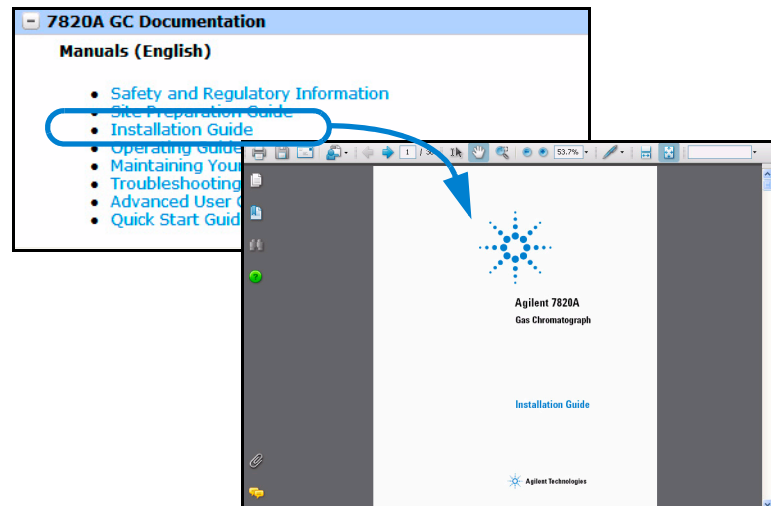

Autres informations

Important

Vous trouverez des versions traduites des consignes de sécurité, de la réglementation, des informations d'utilisation, de maintenance et de dépannage sur le DVD GC and GC/MS Hardware User Information & Utilities Agilent livré avec votre appareil.

Documentation utilisateur en ligne

A présent la documentation de votre appareil Agilent est réunie sur un seul support, à portée de main.



Le DVD GC and GC/MS Hardware User Information & Utilities qui accompagne votre instrument fournit un grand nombre de fichiers d'aide en ligne, de vidéos et de livres spécifiques aux chromatographes en phase gazeuse (CPG), aux détecteurs sélectif de masse (DDM) et aux échantillonneurs CPG Agilent. Sont également incluses des versions traduites des documents dont vous aurez le plus besoin comme :

- Se familiariser avec le CPG
- Guide de sécurité et de réglementation
- Informations sur la préparation du site
- Document d'installation
- Guides d'utilisation
- Manuel de maintenance du CPG
- Manuel de dépannage

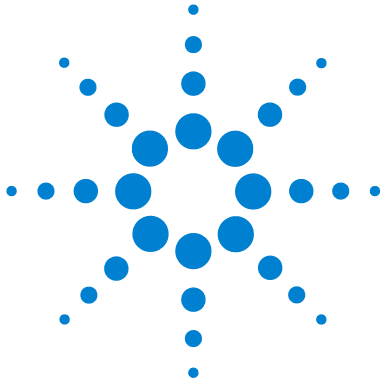

Gasromatografo Agilent 7820A 7820A - Guida rapida

Italiano

1. Utilizzare il DVD "GC and GC/MS Hardware User Information & Utilities".

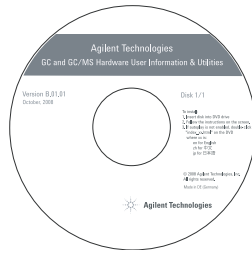

2. Inserire il DVD.

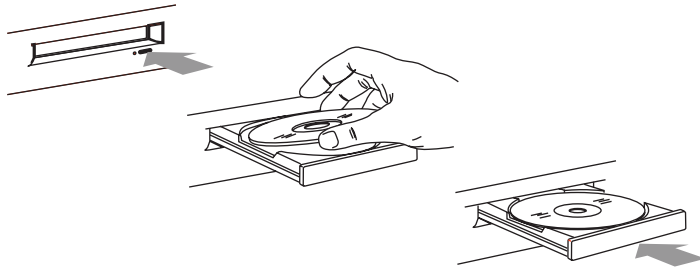

3. Selezionare la lingua.



Agilent Technologies

4. Fare clic su View Hardware Manuals & Videos.

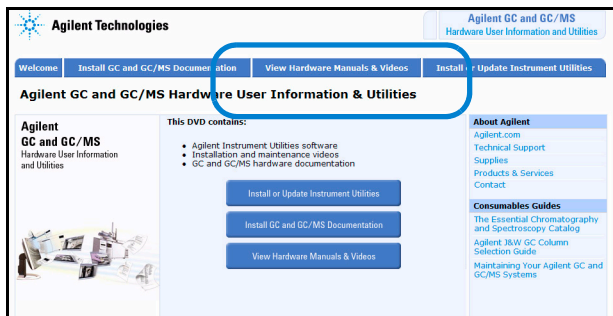

5. Scorrere. Espandere GC Documentation. Espandere 7820A GC Documentation.

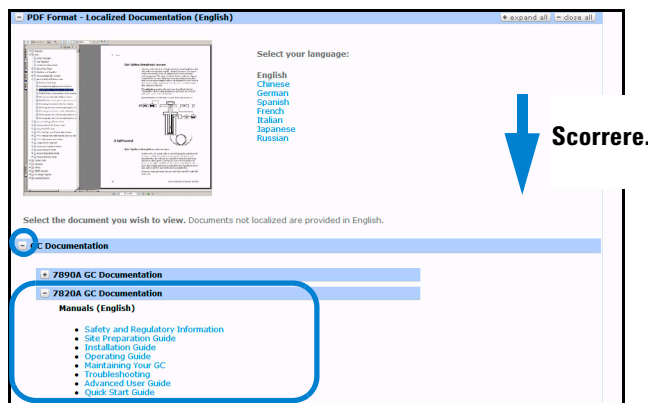

6. Aprire la guida all'installazione. Seguire le istruzioni per installare il GC Agilent 7820A.

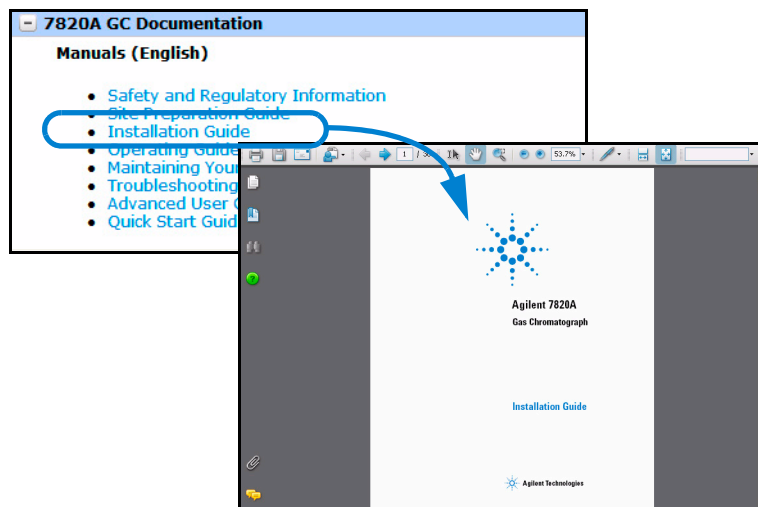

Informazioni aggiuntive

Importante

Consultare il DVD GC e GC/MS Hardware User Information & Utilities fornito con lo strumento per la traduzione delle informazioni sulla sicurezza e le norme vigenti, il funzionamento, la manutenzione e la risoluzione dei problemi.

Documentazione utente online

Oggi la documentazione Agilent è tutta a porta di mano.



Il DVD "GC and GC/MS Hardware User Information & Utilities" di Agilent fornito con lo strumento offre un'ampia raccolta di guide on line, video e manuali sugli attuali gascromatografi, rivelatori a selezione di massa e campionatori GC di Agilent. Sono incluse le traduzioni delle informazioni di cui si ha maggiore necessità, quali:

- Documenti introduttivi agli strumenti
- Informazioni sulla sicurezza e le norme vigenti
- Informazioni sulla preparazione del laboratorio
- Informazioni relative all'installazione
- Manuali operativi
- Informazioni relative alla manutenzione
- Informazioni dettagliate per la risoluzione dei problemi



Agilent 7820A Gaschromatograph 7820A Schnellstarthandbuch

Deutsch

1. Nehmen Sie die DVD „GC and GC/MS Hardware User Information & Utilities“ zur Hand.

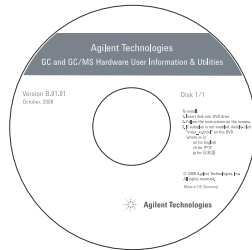

2. Legen Sie die DVD ein.

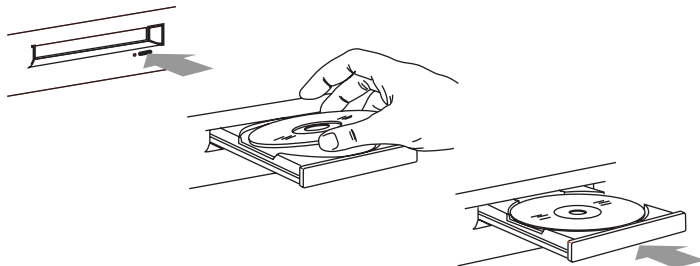

3. Wählen Sie die Sprache aus.



4. Klicken Sie auf „View Hardware Manuals & Videos“.

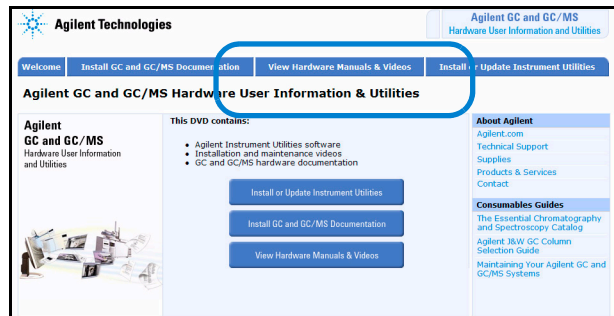

5. Scrollen Sie nach unten. Blenden Sie „GC Documentation“ ein. Blenden Sie „7820A GC Documentation“ ein.

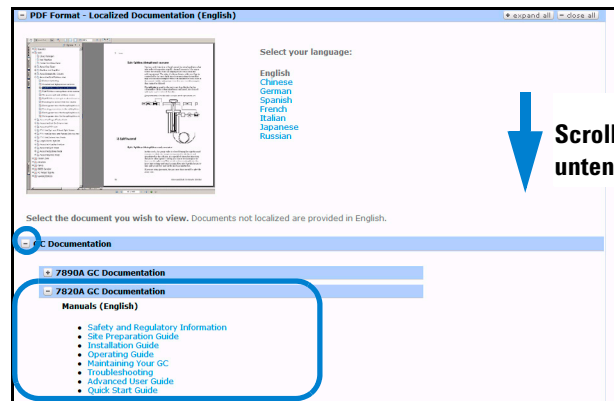

6. Öffnen Sie das Installationshandbuch. Folgen Sie den Anweisungen, um den Agilent 7820A GC zu installieren.

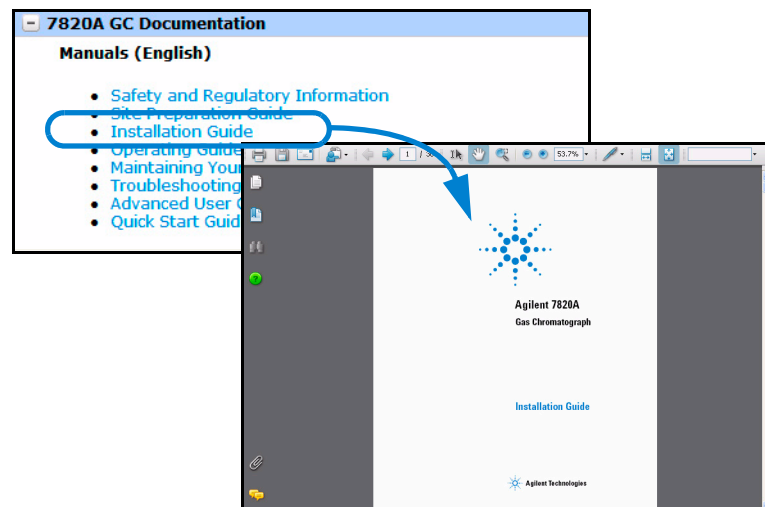

Weitere Informationen

Wichtig

Lokalisierte Informationen zur Sicherheit und Ausführung, zum Betrieb, zur Wartung und zur Problembehebung finden Sie auf der Agilent GC and GC/MS Hardware User Information & Utilities DVD, die im Lieferumfang Ihres Geräts enthalten ist.

Online-Benutzerdokumentation

Die Agilent Gerätedokumentation steht Ihnen nun jederzeit zur Verfügung.



Auf der Agilent GC and GC/MS Hardware User Information & Utilities DVD, die im Lieferumfang Ihres Geräts enthalten ist, befindet sich eine umfangreiche Sammlung an Onlinehilfen, Videos und Bücher für den aktuellen Agilent Gaschromatographen, massenselektive Detektoren und GC- Probengeber. Inbegriffen sind lokalisierte Versionen der wichtigsten Informationen, z. B.:

- Dokumentation zur Einführung in das Gerät
- Handbuch zur Sicherheit und Ausführung
- Informationen zur Standortvorbereitung
- Installationsinformationen
- Benutzerhandbücher
- Wartungsinformationen
- Informationen zur Fehlerbehebung

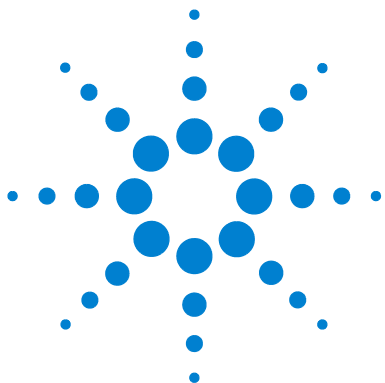

Español

1. Busque el DVD de utilidades e información para el usuario del hardware del GC y GC/MS

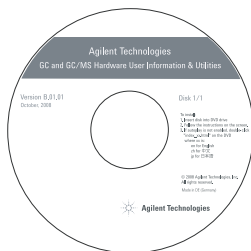

2. Inserte el DVD.

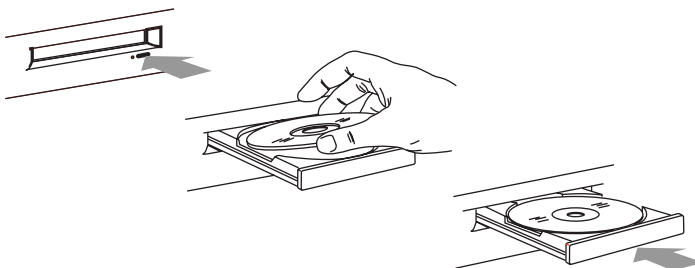

3. Seleccione el idioma.



4. Haga clic en **View Hardware Manuals & Videos.**

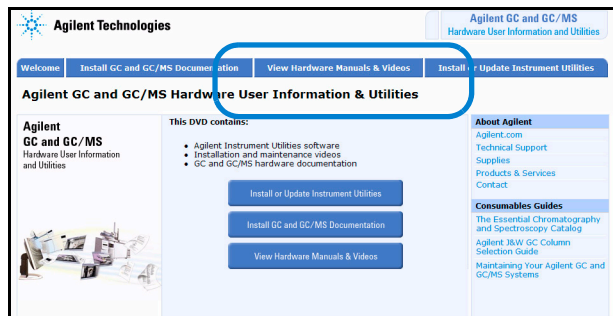

5. Desplácese hacia abajo. Amplíe la documentación del GC. Amplíe la documentación del GC 7820A.

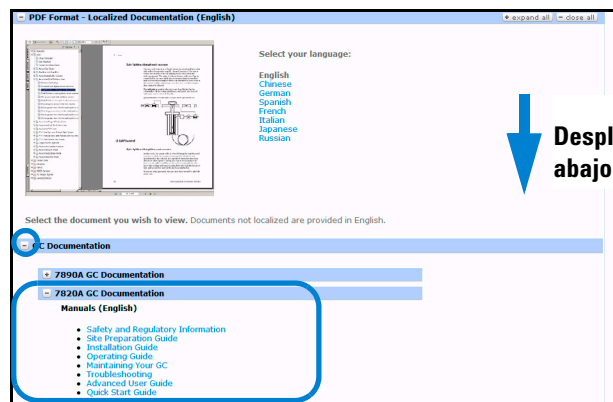

6. Abra la Guía de instalación. Siga las instrucciones para instalar el GC 7820A de Agilent.

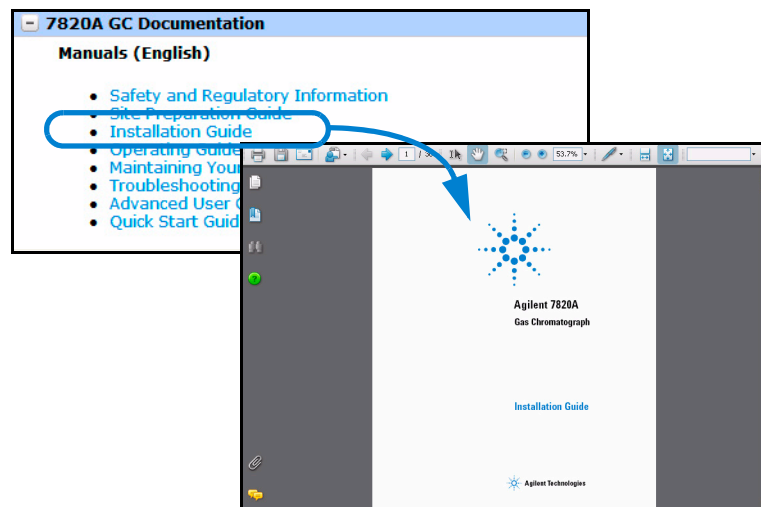

Otra información

Importante

Consulte el DVD de utilidades e información para el usuario del hardware del GC y GC/MS que se suministra con el instrumento para obtener las versiones localizadas de la Información sobre normativas y seguridad, Funcionamiento, Mantenimiento y Solución de problemas.

Documentación en línea para el usuario

Ahora la documentación de los instrumentos Agilent están en un único lugar al alcance de la mano.



El DVD de utilidades e información para el usuario del hardware GC y GC/MS de Agilent, que se suministra con el instrumento, proporciona una amplia colección de ayuda en línea, vídeos y libros para los cromatógrafos de gases, detectores selectivos de masa y muestreadores de GC que comercializa Agilent actualmente. Se incluyen las versiones localizadas de la información más útil, como:

- Documentación para familiarizarse
- Guía de información sobre normativas y seguridad
- Información de preparación del emplazamiento
- Información sobre la instalación
- Guías de funcionamiento
- Información sobre el mantenimiento
- Datos para solucionar problemas



Газовый хроматограф Agilent 7820A Руководство по быстрому началу работы с 7820A

Русский

1. Найдите DVD-диск GC and GC/MS Hardware User Information & Utilities (Информация для пользователя и утилиты оборудования ГХ и ГХ/МСД).

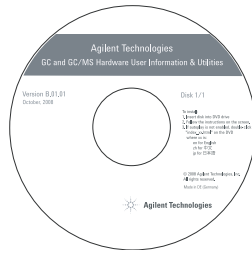

2. Вставьте DVD-диск.

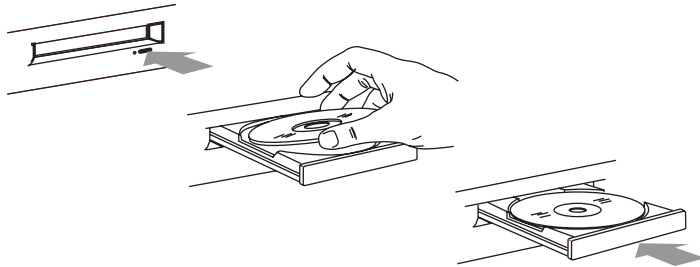

3. Выберите язык.



4. Щелкните «Просмотр руководств и видеозаписей для оборудования».

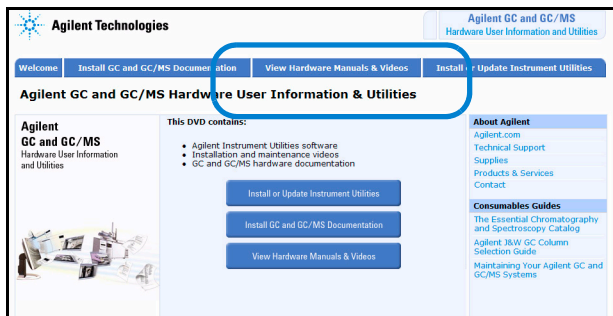

5. Прокрутите вниз. Разверните раздел «Документация ГХ». Разверните раздел «Документация ГХ 7820А».

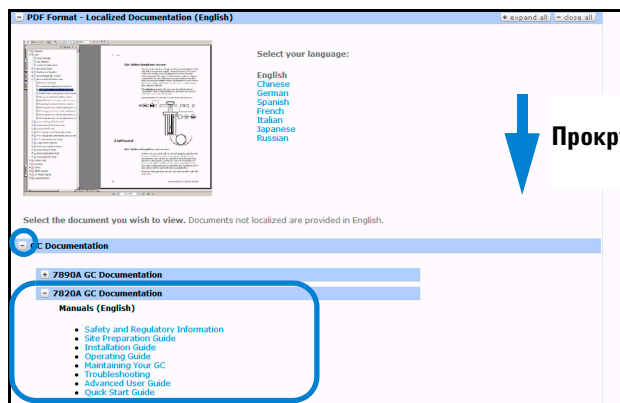

6. Откройте руководство по установке. Следуйте инструкциям по установке ГХ Agilent 7820А.

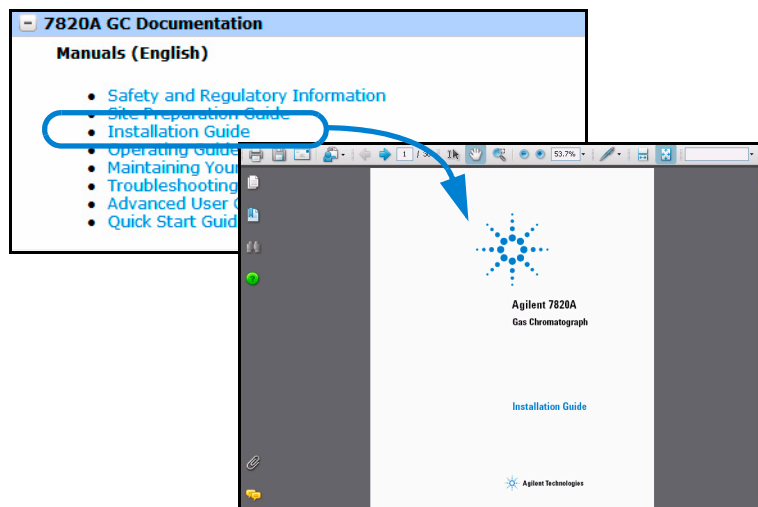

Другая информация

Важная информация

Локализованные версии информации о безопасности и соответствии нормам, работе, обслуживании и устранении неполадок находятся на DVD-диске GC and GC/MS Hardware User Information & Utilities (Информация для пользователя и утилиты оборудования ГХ и ГХ/МСД Agilent).

Экранная документация для пользователей

Теперь документация прибора Agilent легко доступна и находится в одном месте.



К прибору прилагается DVD-диск GC and GC/MS Hardware User Information & Utilities (Информация для пользователя и утилиты оборудования ГХ и ГХ/МСД Agilent), который содержит обширный набор справочных сведений, видеоматериалов и книг для текущих моделей газовых хроматографов, масс-селективных детекторов и пробоотборников ГХ Agilent. Также включены локализованные версии наиболее необходимой информации, в том числе следующие сведения.

- Документация «Знакомство с ГХ».
- Руководство по безопасности и соответствию нормам.
- Сведения о подготовке рабочего места.
- Информация об установке.
- Руководства по работе с ГХ.
- Информация об обслуживании.
- Сведения об устранении неполадок.



Agilent Technologies

© Agilent Technologies, Inc.

Printed in China, April 2009



G4350-90008